

# SF eyephorics / Technical Manual

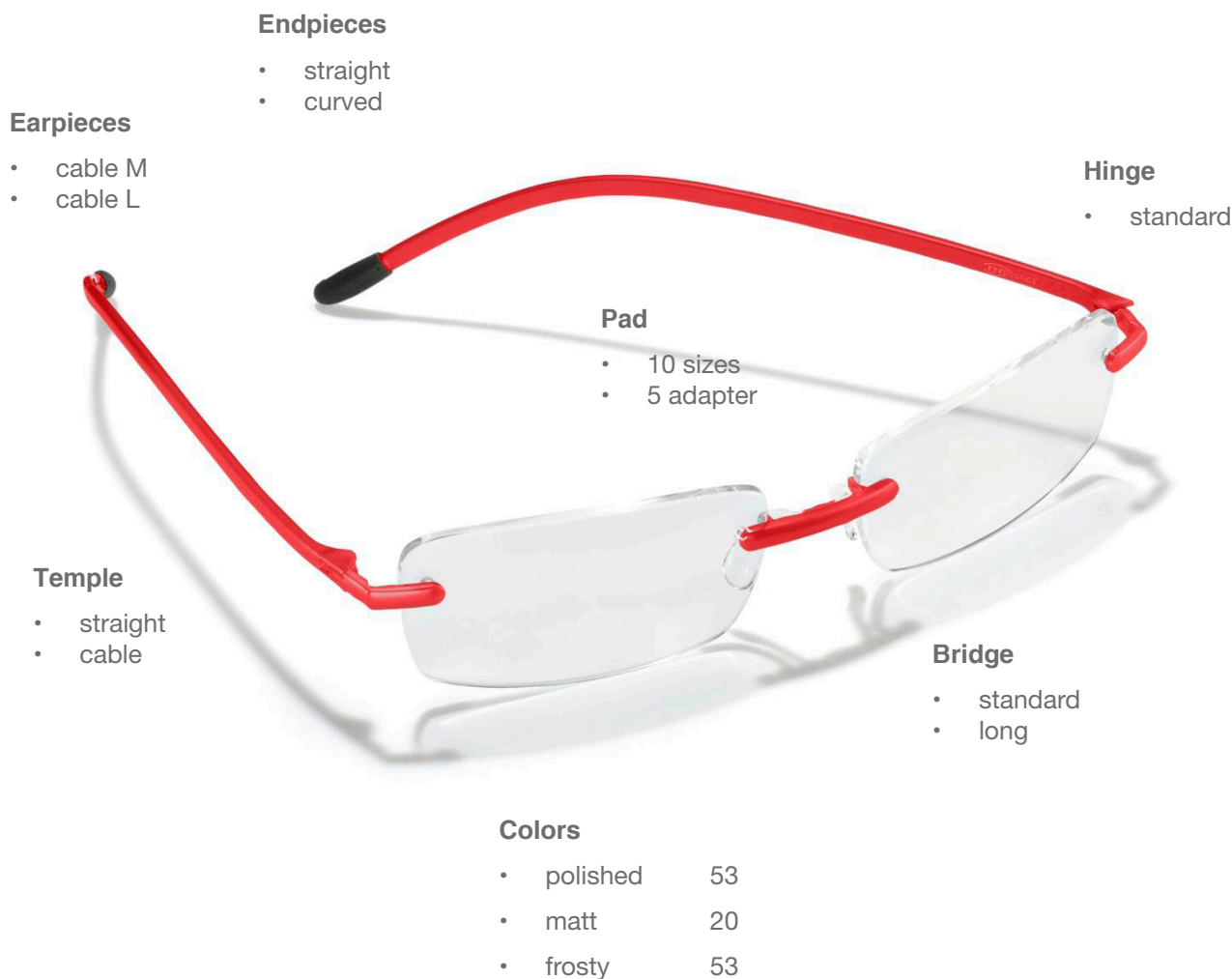

- 1. Frame system**
- 2. Frame parts**
- 3. Devices / Tools**
- 4. Technical data drilling**
- 5. Mounting instructions for straight temple**

# 1. Frame system



Pictures of all the elements above are available in the legend and the color overviews of the order forms.



like  
wearing  
nothing.

**+**  
perfekte Passform  
modulare Individualität  
100% Swiss-made

## 2. Frame parts



- ① Bridge
- ② Nose pad
- ③ Hinge
- ④ Temple
- ⑤ Endpiece

### 3. Devices / Tools

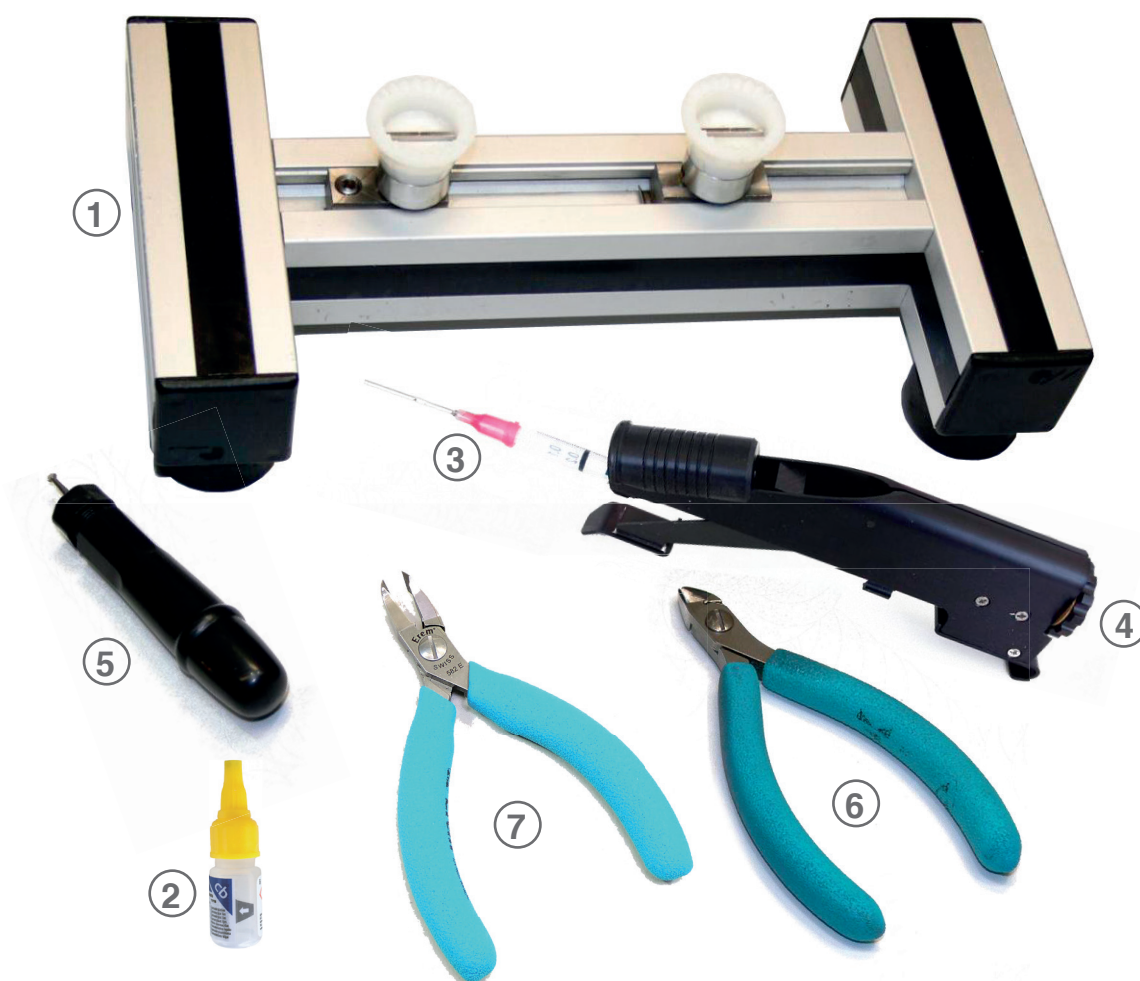

The devices and tools are matched especially for Swissflex and only by using them the optimal mounting quality can be guaranteed.

Tools	Article code
① Glueing station small for 1 frame	70202007
② Special glue for eyephorics	70103003
③ Dosing needle with Teflon	70103002
④ Dispatcher for manual glue	70103001
⑤ Core drill with handle	70003004
⑥ Diagonal cutting nipper straight 632 N	70003005
⑦ Diagonal cutting nipper angled 583 N	70003006

## 4. Technical data drilling

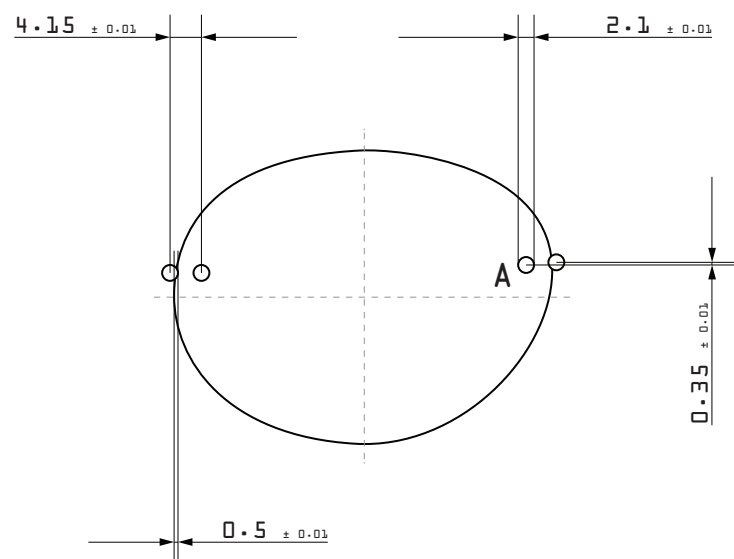
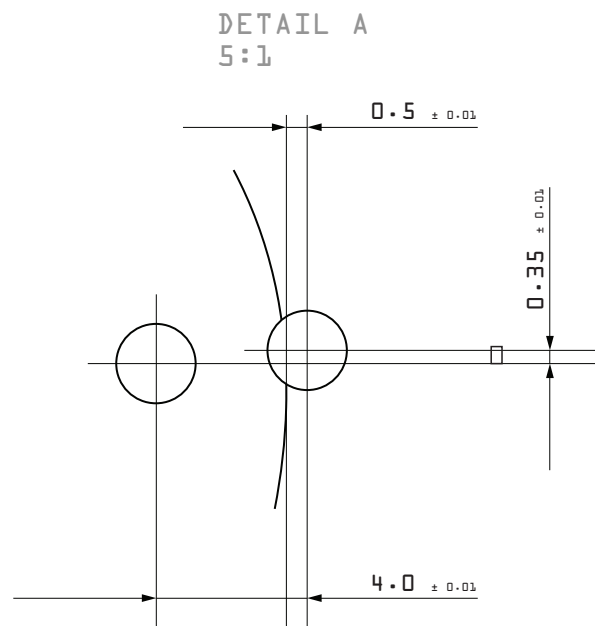

(A minimum glass thickness of 1.8 mm is recommended)

## 5. Mounting instructions for straight temple

- 1 Trim long holes with countersink from both sides.



- 2 Insert bridge and hinges into long holes and press them on firmly.



- 3 Make sure bridge and hinges fit closely to outside of lens.

Cut overlapping bolt (of bridge and hinges) on inside of lens.

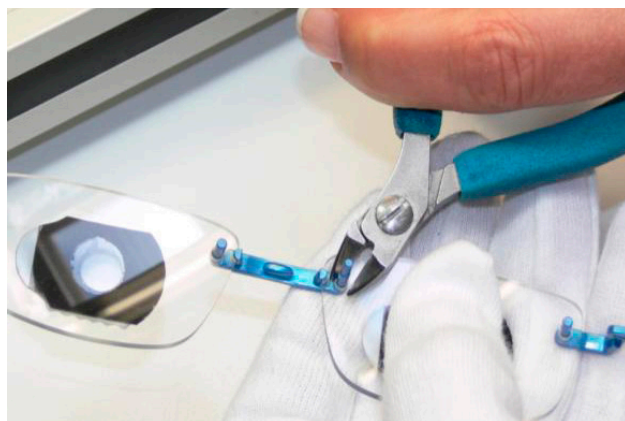

- 4 Click in temple into hinge holding it parallel to front.





- 5 Align eyewear so that temples are lying upon each other.

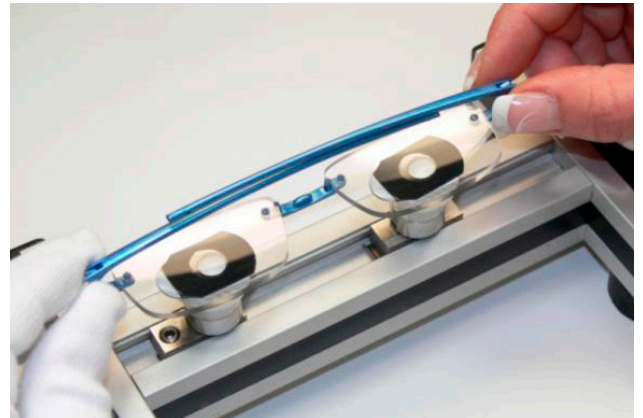

- 6 Let a dosed amount of glue flow around shortened bolts.

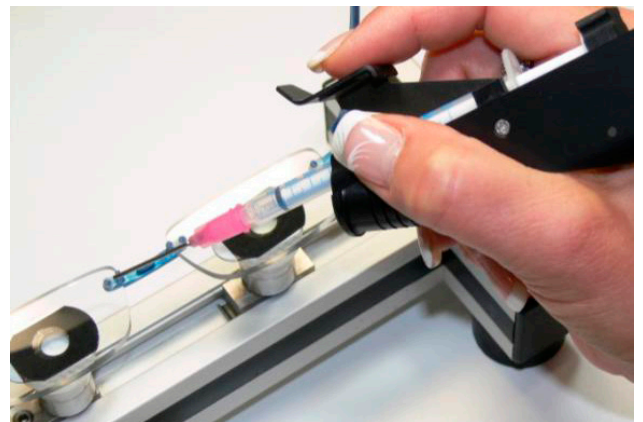

- 7 Remove grinding aid pads from lenses.



- 8 Press pad onto bolt of the bridge with mounting tool.

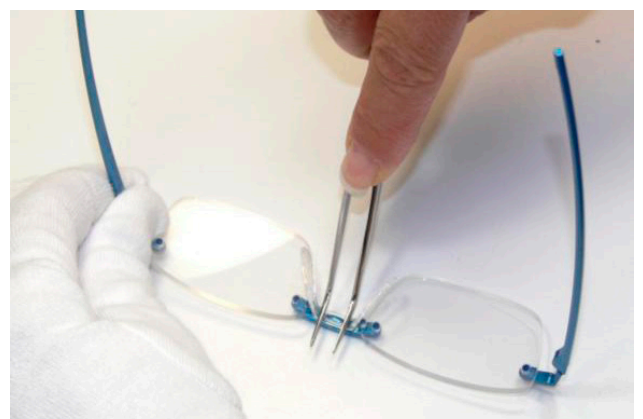

9

Shorten temples according to mark.

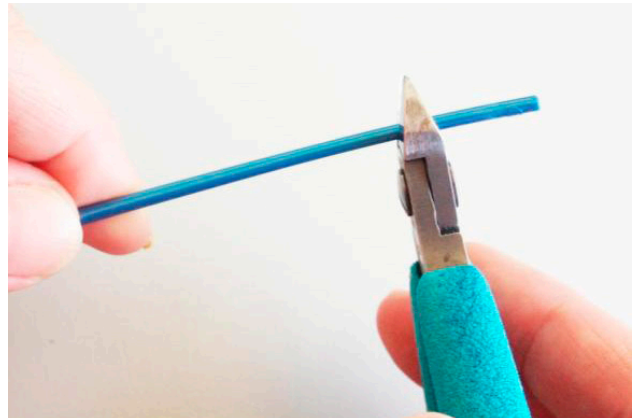

10

Heat end- / earpieces with Ventiletta and mount onto the shortened temples.

Check symmetry and tension of temples and adjust if needed by punctual heat treatment.

Only use Aceton or soap water for cleaning the frame (without lenses).

