

SF airlight / Technical Manual

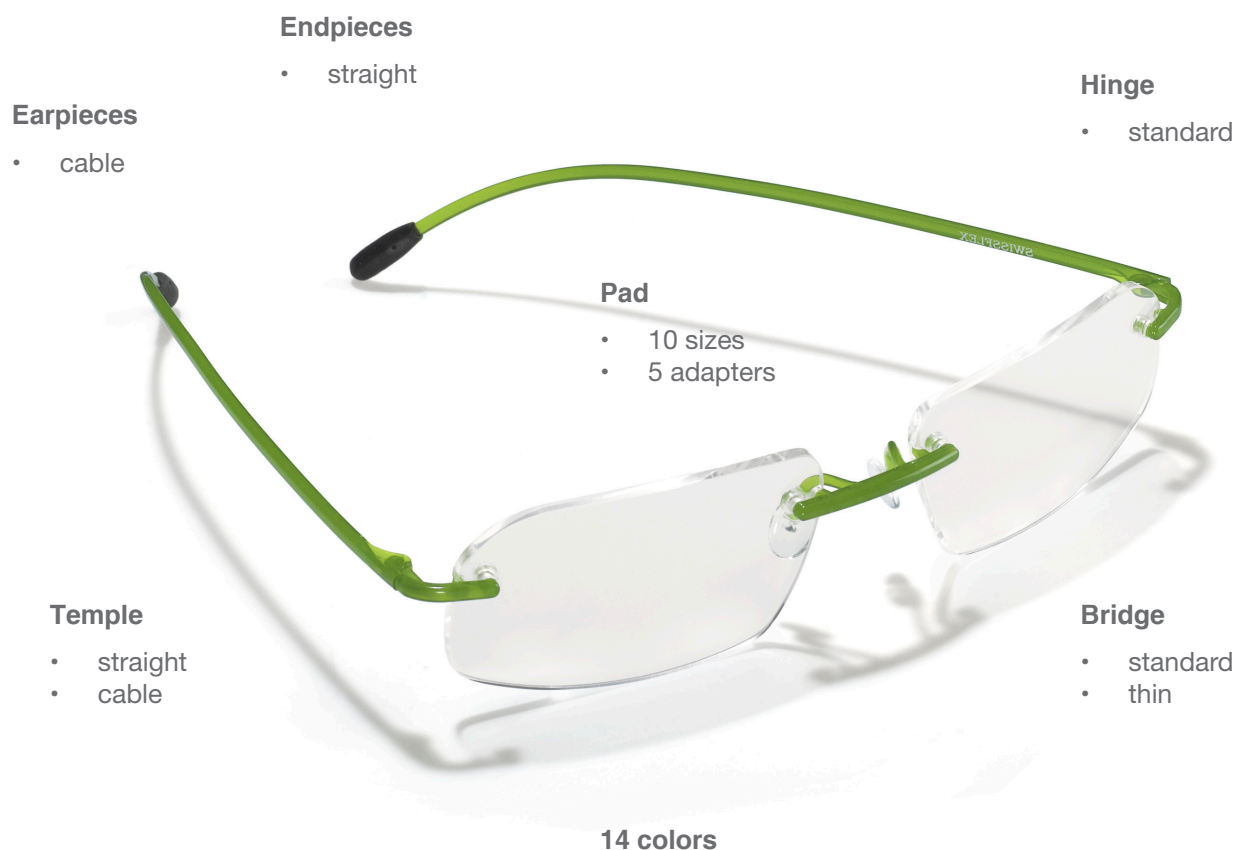

- 1. Frame system**
- 2. Frame parts**
- 3. Devices / Tools**
- 4. Technical data drilling**
- 5. Mounting instructions**

1. Frame system



Pictures of all the elements above are available in the legend and the color overviews of the order forms.



like
wearing
nothing.

+
perfekte Passform
modulare Individualität
100% Swiss-made

2. Frame parts



- ① Bridge
- ② Nose pad
- ③ Hinge
- ④ Temple
- ⑤ Endpiece

3. Devices / Tools



The devices and tools are matched especially for Swissflex and only by using them the optimal mounting quality can be guaranteed.

Tools	Article code
① Demounting device Demounting top	70211042 70111043
② Rivet device Rivet top Rivet countereffect	70211041 70111041 70111042
③ SFA Mounting plier	70111048
④ Metal spacer	70111046
⑤ Core drill with handle	70003004
⑥ Diagonal cutting nipper 632N	70003005
⑦ Diagonal cutting nipper 582N	70003006

4. Technical data drilling

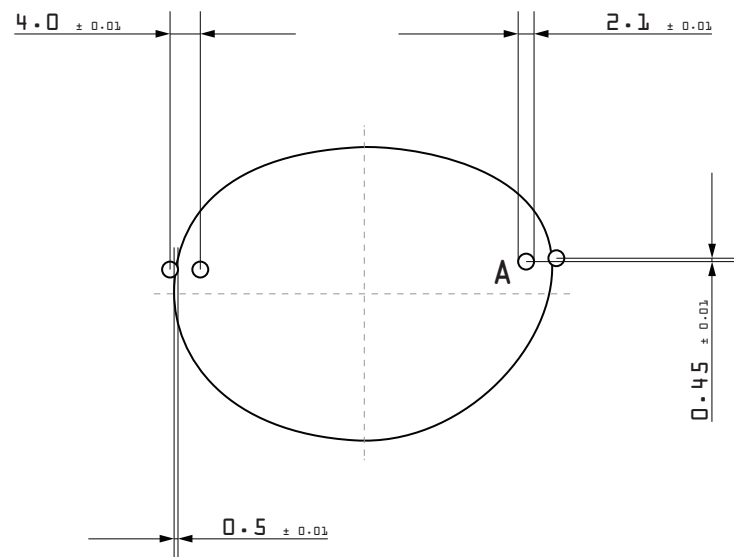
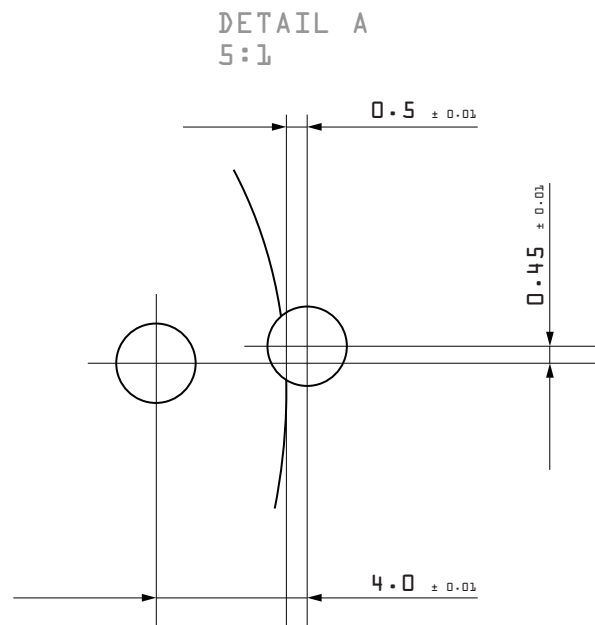

(A minimum glass thickness of 1.8 mm is recommended)

5. Mounting instructions for straight temple

1

Burring long holes with core drill from both sides.



2

Insert bridge and hinges into long holes and press them on firmly.



3

Make sure, that bridge and hinges rest firmly on the outside of the lens.

Put on rings and press them on firmly with the mounting plier.



4

Put metal spacer onto rings and cut back overlaying part closely.

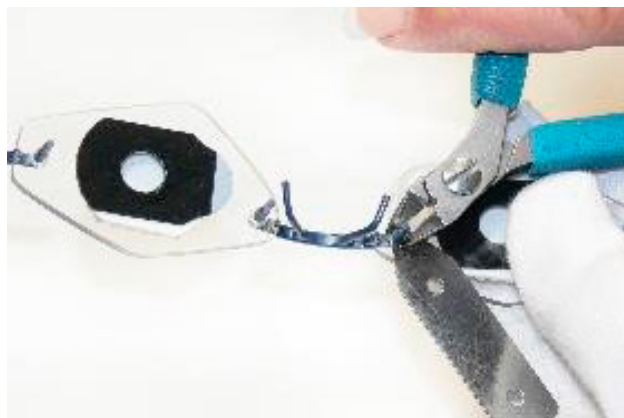

- 5 Rivet rings with pre-heated tip of rivet (200° +/- 10°).



- 6 Click in temples into hinge parallel to front.



- 7 Heat pads and mount them on pad arms.



- 8 Cut off length of temples according marking.



9

Heat end- / earpieces with Ventiletta and mount them on the shortened temples.

Check symmetry and opening of temples and adjust by applying punctual heat if necessary.

For cleaning of frame (without lens) kindly use tested cleanser only (see listing).

